



UTILITY PIPE FITTINGS AND ACCESSORIES



Star® Pipe Products
4018 Westhollow Pkwy.
Houston, TX 77082

Toll-Free: (800) 999-3009
Tel: (281) 558-3000
Fax: (281) 558-9000

www.starpipeproducts.com

General Terms and Conditions

GENERAL	These terms and conditions shall control with respect to any purchase order or sale of Seller's products. No waiver, alteration or modification of these terms and conditions whether on Buyer's purchase order or otherwise shall be valid unless the waiver, alteration or modification is specifically accepted in writing and signed by an authorized representative of Seller.
DELIVERY	Seller will make every effort to complete delivery of products as indicated on Seller's acceptance of an order, but Seller assumes no responsibility or liability, and will accept no back charge, for loss or damage due to delay or inability to deliver caused by acts of God, war, labor difficulties, accident, delays of carriers, by contractors or suppliers, inability to obtain materials, shortages of fuel and energy, or any other causes of any kind whatsoever beyond the control of Seller. Seller may terminate any contract of sale of its products without liability of any nature, by written notice to Buyer, in the event that the delay in delivery or performance resulting from any of the aforesaid causes shall continue for a period of sixty (60) days. Under no circumstances shall Seller be liable for any special or consequential damages or for loss, damage, or expense (whether or not based on negligence) directly or indirectly arising from delays or failure to give notice of delay.
WARRANTY	Seller warrants for one year from the date of shipment Seller's manufactured products to the extent that Seller will replace those having defects in material or workmanship when used for the purpose and in the manner which Seller recommends. If Seller's examination shall disclose to its satisfaction that the product is defective, and an adjustment is required, the amount of such adjustment shall not exceed the net sales price of the defective products only and no allowance will be made for labor or expense of repairing or replacing defective product or workmanship or damage resulting from the same. No adjustment shall be implemented unless product in question is returned to seller in its originally installed condition, still connected to other components of the joint. Buyer must contact Seller as quickly as possible so Seller can assess product in its installed condition. No claims will be honored unless claim is made within forty five (45) days of the defect being found. Where engineering design or fabrication work is supplied, Buyer's acceptance of Seller's design or of delivery of work shall relieve Seller of all further obligation, other than expressed in Seller's product warranty. THIS IS SELLER'S SOLE WARRANTY. SELLER MAKES NO OTHER WARRANTY OF ANY KIND, EXPRESSED OR IMPLIED AND ALL IMPLIED WARRANTIES OF MERCHANTABILITY AND FITNESS FOR A PARTICULAR PURPOSE WHICH EXCEED SELLER'S AFORE STATED OBLIGATION ARE HEREBY DISCLAIMED BY SELLER AND EXCLUDED FROM THIS WARRANTY. Seller neither assumes, nor authorizes any person to assume for it, any other obligation in connection with the sale of its engineering designs or product. This warranty shall not apply to any products or parts of products which (a) have been repaired or altered outside of Seller's factory, in any manner; (b) have been subjected to misuse, negligence or accidents; (c) have been used in a manner contrary to Seller's instructions or recommendations. Seller shall not be responsible for design errors due to inaccurate or incomplete information supplied by Buyer or its representatives. This warranty is non-transferable.
LIABILITY	Seller will not be liable for any loss, damage, cost of repairs, incidental or consequential damages of any kind, whether based upon warranty (except for the obligation accepted by Seller under "Warranty" above), contract or negligence, arising in connection with the design, manufacture, sale, use or repair of the products or of the engineering designs supplied to Buyer.
RETURNS	Seller cannot accept return of any products unless its written permission has been first obtained, in which case same will be credited subject to the following: (a) All material returned must, on its arrival at Seller's plant, be found to be in first-class condition; if not, cost of putting in saleable condition will be deducted from credit memoranda; (b) A handling charge deduction of twenty-five percent (25%) will be made from all credit memoranda issued for material returned; (c) Transportation charges, if not prepaid will be deducted from credit memoranda.
SHIPMENTS	All products sent out will be carefully examined, counted and packed. The cost of any special packing or special handling caused by Buyer's requirements or requests shall be added to the amount of the order. No claim for shortages will be allowed unless made in writing within ten (10) days of receipt of a shipment. Claims for products damaged or lost in transit should be made on the carrier, as Seller's responsibility ceases, and title passes, on delivery to the carrier.
PRODUCTS	Orders covering special or non-standard products are not subject to cancellation except on such terms as Seller may specify on application.
PRICES	Prices and designs are subject to change without notice. All prices are F.O.B. Point of Shipment, unless otherwise stated.
TAXES	The amount of any sales, excise or other taxes, if any, applicable to the products covered by this order, shall be added to the purchase price and shall be paid by Buyer unless Buyer provides Seller with an exemption certificate acceptable to the taxing authorities.

STAR[®] PIPE PRODUCTS

UCAT.12.01
*REGISTERED TRADEMARK OF STAR PIPE PRODUCTS

STAR PIPE PRODUCTS
HOUSTON CORPORATE TOLL FREE 1-800-999-3009 FAX 281-558-9000
www.starpipeproducts.com





Compact Push-On Fittings

ANSI/AWWA C153/A21.53

4" - 24" DUCTILE IRON PUSH-ON JOINT COMPACT FITTINGS

GENERAL SPECIFICATIONS

- MATERIAL:** Ductile iron per ASTM A536
- PRESSURE:** 350 PSI rating for 4" - 24" sizes. Pressure rating applies to fittings only and does not apply to restraining lugs or external restrainers
- TESTING:** In accordance with ANSI/AWWA C153/A21.53 and UL requirements
- LAYING LENGTH:** In accordance with ANSI/AWWA C153/A21.53 (fittings not listed in ANSI/AWWA have dimensions per Star design as noted in the catalog)
- WEIGHTS:** Are in pounds, unless noted otherwise and do not include accessories, cement lining and coating
- FLANGES:** Flanged ends on fittings match ANSI/AWW C115/A21.15 and ANSI B16.1 class 125 flanges
- CEMENT LINING:** In accordance with ANSI/AWWA C104/A21.4 -- sizes 4" - 24" double thickness
- COATING:** Asphaltic seal coat inside and out in accordance with ANSI/AWWA C104/A21.4 and referenced in ANSI/AWWA C153/A21.53
- GASKETS:** Dual hardness SBR in accordance with ANSI/AWWA C111/A21.11 (see pg. 37)
- APPROVALS:** 4" - 12" Underwriters Laboratories Listed. Please consult factory for detail listing and approvals. 4" and greater are UL/NSF-61
- DIMENSIONS:** All dimensions are in inches unless noted otherwise.

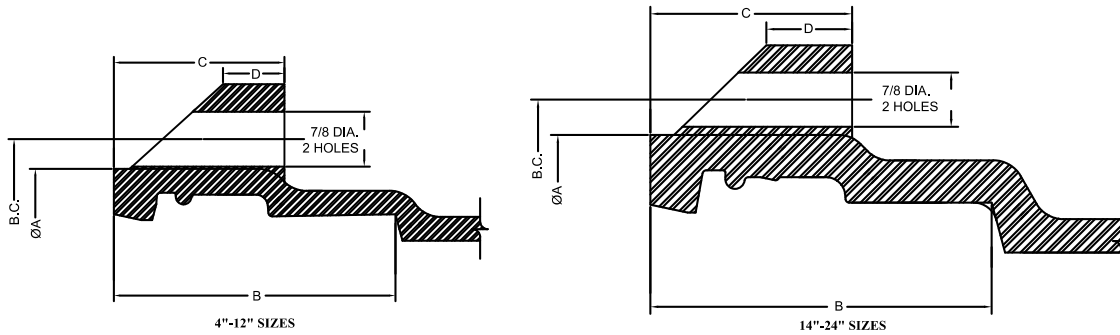

WATER QUALITY

PUSH-ON JOINT DIMENSIONS

NOM. SIZE	ØA	B.C.	B	C	D
4	6.38	7.50	4.02	2.17	1.12
6	8.52	9.56	4.02	2.17	1.12
8	10.80	11.82	4.49	2.72	1.12
10	12.91	14.00	4.49	2.91	1.12
12	15.05	16.25	5.00	2.99	1.12
14	17.89	18.75	5.50	3.12	1.25
16	20.05	21.00	5.50	3.25	1.25
18	22.35	23.25	5.50	3.25	1.25
20	24.47	25.50	5.50	3.25	1.25
24	28.79	30.00	6.00	3.25	1.25



Please note: All fittings are standard with two (2) restraining lugs. Bends 45° & 90° in sizes 4" - 12" are also available with four (4) restraining lugs.



STAR[®] PIPE PRODUCTS



Compact Push-On Fittings

ANSI/AWWA C153/A21.53

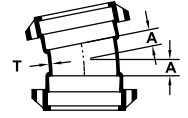
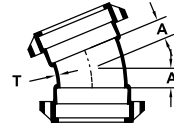
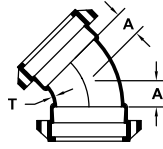
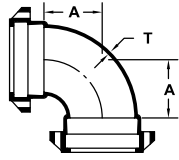

PO x PO BENDS		90° PO x PO BENDS (1/4)		45° PO x PO BENDS (1/8)		22 1/2° PO x PO BENDS (1/6)		11 1/4° PO x PO BENDS (1/32)	
NOM. SIZE	T	A	WT (LBS.)	A	WT (LBS.)	A	WT (LBS.)	A	WT (LBS.)
4	0.34	4.00	26	2.00	23	1.50	22	1.25	21
6	0.36	5.00	41	3.00	38	2.00	34	1.50	32
8	0.38	6.50	71	3.50	54	2.50	55	1.75	52
10	0.40	7.50	98	4.50	87	3.00	75	2.00	67
12	0.42	8.75	139	5.50	110	3.50	105	2.25	95
14	0.47	11.50	254	5.00	143	3.75	162	2.50	113
16	0.50	12.50	275	5.50	206	3.75	168	2.50	172
18	0.54	14.00	391	6.00	309	4.50	209	3.00	209
20	0.57	15.00	476	7.00	351	4.50	400	3.00	265
24	0.61	17.00	704	7.50	414	7.50	410	3.00	315

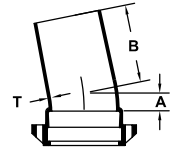
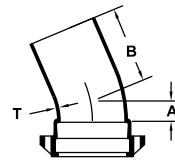
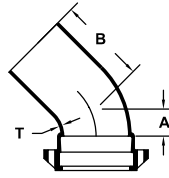
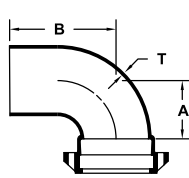

PO x PE BENDS		90° PO x PE BENDS (1/4)			45° PO x PE BENDS (1/8)			22 1/2° PO x PE BENDS (1/6)			11 1/4° PO x PE BENDS (1/32)		
NOM. SIZE	T	A	B	WT (LBS.)	A	B	WT (LBS.)	A	B	WT (LBS.)	A	B	WT (LBS.)
4	0.34	4.00	10.50	24	2.00	8.00	21	1.50	8.00	19	1.25	7.00	18
6	0.36	5.00	12.00	47	3.00	9.00	38	2.00	8.00	35	1.50	7.25	34
8	0.38	6.50	13.00	75	3.50	9.50	60	2.50	8.50	57	1.75	7.50	55

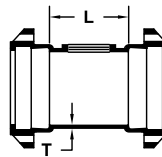
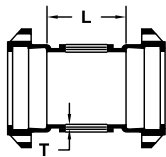

PO x TAPPED CROSS				
NOM. SIZE	T	L	MAX. TAP	WT (LBS.)
4	0.34	6.00	3	35
6	0.36	6.00	3	45
8	0.38	6.00	3	61
10	0.40	6.00	3	100
12	0.42	6.00	3	140

Threads in Accordance with ANSI/ASME B1.20.1

PO x TAPPED TEE				
NOM. SIZE	T	L	MAX. TAP	WT (LBS.)
4	0.34	6.00	3	35
6	0.36	6.00	3	45
8	0.38	6.00	3	61
10	0.40	6.00	3	100
12	0.42	6.00	3	140

Threads in Accordance with ANSI/ASME B1.20.1

STAR® PIPE PRODUCTS





Compact Push-On Fittings

ANSI/AWWA C153/A21.53

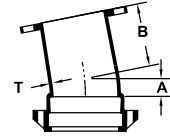
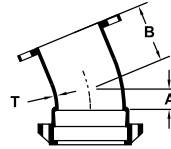
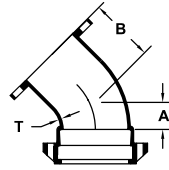
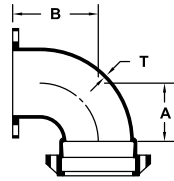

PO x FE BENDS		90° PO x FE BENDS (1/4)			45° PO x FE BENDS (1/8)			22 1/2° PO x FE BENDS (1/16)			11 1/4° PO x FE BENDS (1/32)		
NOM. SIZE	T	A	B	WT (LBS.)	A	B	WT (LBS.)	A	B	WT (LBS.)	A	B	WT (LBS.)
4	0.34	4.50	6.50	33	2.00	4.00	21	1.50	4.00	25	1.25	4.00	24
6	0.36	5.50	8.00	47	3.00	5.00	42	2.00	5.00	44	1.50	5.00	30
8	0.38	6.50	9.00	76	3.50	5.50	60	2.50	5.50	64	1.75	5.50	61
10	0.40	7.50	11.00	130	4.50	6.50	93	3.00	6.50	90	2.00	6.50	80
12	0.42	8.75	12.00	158	5.50	7.50	122	3.50	7.50	112	2.25	7.50	94
14	0.47	11.50	14.00	231	5.00	7.50	162	3.75	7.50	174	2.50	7.50	170
16	0.50	12.50	15.00	350	5.50	8.00	275	3.75	8.00	228	2.50	8.00	228
24	0.61	17.00	22.00	---	---	---	---	---	---	---	---	---	---

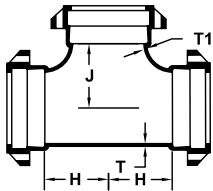

PO x PO TEES					
NOM. SIZE	T	T1	H	J	WT (LBS.)
4 x 4	0.34	0.34	4.00	4.00	40
6 x 4	0.36	0.34	4.00	5.00	50
6 x 6	0.36	0.36	5.00	5.00	59
8 x 4	0.38	0.34	4.00	6.50	75
8 x 6	0.38	0.36	5.00	6.50	88
8 x 8	0.38	0.38	6.50	6.50	99
10 x 4	0.40	0.34	4.00	7.50	95
10 x 6	0.40	0.36	5.00	7.50	103
10 x 8	0.40	0.38	6.50	7.50	122
10 x 10	0.40	0.40	7.50	7.50	134
12 x 4	0.42	0.34	4.00	8.75	122
12 x 6	0.42	0.36	5.00	8.75	126
12 x 8	0.42	0.38	6.50	8.75	148
12 x 10	0.42	0.40	7.50	8.75	161
12 x 12	0.42	0.42	8.75	8.75	192
14 x 6	0.47	0.36	6.50	10.50	176
14 x 10	0.47	0.40	8.50	10.50	195
14 x 12	0.47	0.42	9.50	10.50	196
14 x 14	0.47	0.47	10.50	10.50	209

(Con't)➡

PO x PO TEES (Con't)					
NOM. SIZE	T	T1	H	J	WT (LBS.)
16 x 6	0.50	0.36	6.50	11.50	221
16 x 8	0.50	0.38	7.50	11.50	257
16 x 10	0.50	0.40	8.50	11.50	232
16 x 12	0.50	0.42	9.50	11.50	288
16 x 14	0.50	0.47	10.50	11.50	349
16 x 16	0.50	0.50	12.50	12.50	460
18 x 6	0.54	0.36	6.50	12.50	320
18 x 8	0.54	0.38	7.50	12.50	325
18 x 10	0.54	0.40	8.50	12.50	344
18 x 12	0.54	0.42	9.50	12.50	385
18 x 14	0.54	0.47	10.50	12.50	352
18 x 16	0.54	0.50	11.50	12.50	362
18 x 18	0.54	0.54	14.00	14.00	550
20 x 6	0.57	0.36	6.50	14.00	355
20 x 10	0.57	0.40	9.00	14.00	369
20 x 12	0.57	0.42	10.00	14.00	457
20 x 14	0.57	0.47	11.00	14.00	484
20 x 16	0.57	0.50	12.00	14.00	610
20 x 18	0.57	0.54	13.00	14.00	639
20 x 20	0.57	0.57	15.00	15.00	644
24 x 6	0.61	0.36	7.00	16.00	450
24 x 8	0.61	0.38	8.00	16.00	492
24 x 10	0.61	0.40	9.00	16.00	520
24 x 12	0.61	0.42	10.00	16.00	541
24 x 14	0.61	0.47	11.00	16.00	715
24 x 16	0.61	0.50	12.00	16.00	755
24 x 18	0.61	0.54	13.00	16.00	708
24 x 20	0.61	0.57	14.00	16.00	845
24 x 24	0.61	0.61	17.00	17.00	884

STAR[®] PIPE PRODUCTS





Compact Push-On Fittings

ANSI/AWWA C153/A21.53

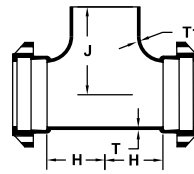
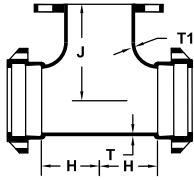

PO x FE TEES					
NOM. SIZE	T	T1	H	J	WT (LBS.)
4 x 4	0.34	0.34	4.50	6.50	47
6 x 4	0.36	0.34	4.50	8.00	60
6 x 6	0.36	0.36	5.50	8.00	69
8 x 4	0.38	0.34	4.50	9.00	81
8 x 6	0.38	0.36	5.50	9.00	87
8 x 8	0.38	0.38	6.50	9.00	115
10 x 4	0.40	0.34	4.50	11.00	97
10 x 6	0.40	0.36	5.50	11.00	114
10 x 8	0.40	0.38	6.50	11.00	133
10 x 10	0.40	0.40	7.50	11.00	165
12 x 4	0.42	0.34	4.50	12.00	125
12 x 6	0.42	0.36	5.50	12.00	131
12 x 8	0.42	0.38	6.50	12.00	166
12 x 10	0.42	0.40	7.50	12.00	142
12 x 12	0.42	0.42	8.75	12.00	210
16 x 6	0.50	0.36	6.50	15.00	236
16 x 8	0.50	0.38	7.50	15.00	269
16 x 10	0.50	0.40	8.50	15.00	310
16 x 12	0.50	0.42	9.50	15.00	348
16 x 14	0.50	0.47	10.50	15.00	342
16 x 16	0.50	0.50	11.50	15.00	355
18 x 6	0.54	0.36	6.50	15.50	301
18 x 8	0.54	0.38	7.50	15.50	319
18 x 10	0.54	0.40	8.50	15.50	337
18 x 14	0.54	0.47	10.50	15.50	393
18 x 16	0.54	0.50	11.50	15.50	420
20 x 6	0.57	0.36	6.50	17.00	341
20 x 10	0.57	0.40	9.00	17.00	420
20 x 14	0.57	0.47	11.00	17.00	474
20 x 16	0.57	0.50	12.00	18.00	498
20 x 18	0.57	0.54	13.00	18.00	528
24 x 6	0.61	0.36	7.00	19.00	420
24 x 10	0.61	0.40	9.00	19.00	468
24 x 12	0.61	0.42	10.00	19.00	503
24 x 14	0.61	0.47	11.00	19.00	531
24 x 16	0.61	0.50	12.00	19.00	555

PO x PE TEES					
NOM. SIZE	T	T1	H	J	WT (LBS.)
6 x 6	0.36	0.36	5.00	11.50	55
8 x 6	0.38	0.36	5.00	12.50	75
12 x 6	0.42	0.36	5.00	15.50	130

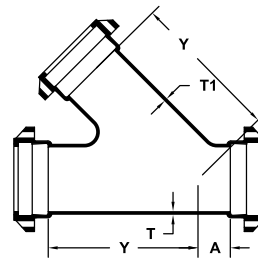

45° PO LATERALS					
NOM. SIZE	T	T1	A	Y	WT (LBS.)
4 x 4	0.34	0.34	2.50	9.50	55
6 x 4	0.36	0.34	3.00	13.00	76
6 x 6	0.36	0.36	3.00	13.00	85
8 x 4	0.38	0.34	3.50	16.00	89
8 x 6	0.38	0.36	3.50	16.00	125
8 x 8	0.38	0.38	3.50	16.00	140
10 x 4	0.40	0.34	3.50	19.00	144
10 x 6	0.40	0.36	3.50	19.00	154
10 x 8	0.40	0.38	3.50	19.00	160
10 x 10	0.40	0.40	3.50	19.00	170
12 x 4	0.42	0.34	4.50	22.50	224
12 x 6	0.42	0.36	4.50	22.50	236
12 x 8	0.42	0.38	4.50	22.50	259
12 x 10	0.42	0.40	4.50	22.50	282
12 x 12	0.42	0.42	4.50	22.50	300
14 x 6	0.47	0.36	0.00	19.50	236
14 x 8	0.47	0.38	1.50	21.00	255
14 x 10	0.47	0.40	3.00	22.50	325
14 x 14	0.47	0.47	6.00	25.00	475
16 x 6	0.50	0.36	0.00	21.00	281
16 x 8	0.50	0.38	1.00	22.50	305
16 x 12	0.50	0.42	3.50	25.00	346
16 x 16	0.50	0.50	6.00	28.00	380
18 x 18	0.75	0.75	7.00	29.00	812

STAR[®] PIPE PRODUCTS

UCAT.12.01
 *REGISTERED TRADEMARK OF STAR PIPE PRODUCTS





Compact Push-On Fittings

ANSI/AWWA C153/A21.53

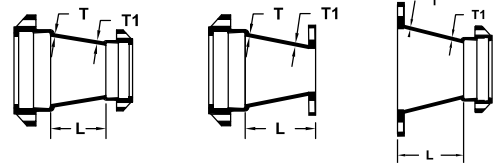
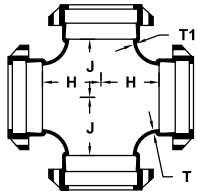

PO CROSSES					
NOM. SIZE	T	T1	H	J	WT (LBS.)
4 x 4	0.34	0.34	4.00	4.00	55
6 x 6	0.36	0.36	5.00	5.00	74
8 x 6	0.38	0.36	5.00	6.50	103
8 x 8	0.38	0.38	6.50	6.50	115
10 x 4	0.40	0.34	4.00	7.50	116
10 x 8	0.40	0.38	6.50	7.50	150
10 x 10	0.40	0.40	7.50	7.50	160
12 x 8	0.42	0.38	6.50	8.75	171
12 x 10	0.42	0.40	7.50	8.75	176
12 x 12	0.42	0.42	8.75	8.75	216
14 x 6	0.47	0.36	6.50	10.50	189
14 x 8	0.47	0.38	7.50	10.50	204
14 x 10	0.47	0.40	8.50	10.50	222
14 x 12	0.47	0.42	9.50	10.50	239
14 x 14	0.47	0.47	10.50	10.50	270
16 x 6	0.50	0.36	6.50	11.50	234
16 x 8	0.50	0.38	7.50	11.50	245
16 x 10	0.50	0.40	8.50	11.50	268
16 x 12	0.50	0.42	9.50	11.50	274
16 x 14	0.50	0.47	10.50	11.50	322
16 x 16	0.50	0.50	12.50	12.50	417
24 x 24	0.61	0.61	17.00	17.00	1056

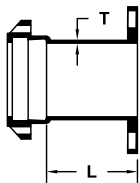

PO x FLANGE ADAPTER			
NOM. SIZE	T	L	WT (LBS.)
4	0.34	3.50	22
6	0.36	3.50	34
8	0.38	3.50	46
10	0.40	3.50	59
12	0.42	3.50	98
14	0.47	5.00	113
16	0.50	5.00	180
24	0.61	5.00	308

NOM. SIZE	T	T1	PO x PO		PO x FE		FE x PO	
			L	WT (LBS.)	L	WT (LBS.)	L	WT
6 x 4	0.36	0.34	4.00	30	6.00	32		
8 x 4	0.38	0.34	5.00	42	7.00	46		
8 x 6	0.38	0.36	4.00	43	6.00	47	6.00	45
10 x 4	0.40	0.34	7.00	53	9.00	55		
10 x 6	0.40	0.36	5.00	58	7.00	59		
10 x 8	0.40	0.38	4.00	62	6.00	61		
12 x 4	0.42	0.34	9.00	70	11.00	78		
12 x 6	0.42	0.36	7.00	77	9.00	73		
12 x 8	0.42	0.38	5.00	80	7.00	74		
12 x 10	0.42	0.40	4.00	82	6.00	95		
14 x 6	0.47	0.36	9.00	84	11.00	121		
14 x 8	0.47	0.38	7.00	85	9.00	128		
14 x 10	0.47	0.40	5.00	87	7.00	127		
14 x 12	0.47	0.42	4.00	104	6.00	144		
16 x 6	0.50	0.36	11.00	138	13.00	133		
16 x 8	0.50	0.38	9.00	137	11.00	141		
16 x 10	0.50	0.40	7.00	130	9.00	158		
16 x 12	0.50	0.42	5.00	135	7.00	172		
16 x 14	0.50	0.47	4.00	139	6.00	196		
18 x 8	0.54	0.38	13.00	140	16.00	157		
18 x 10	0.54	0.40	10.00	142	14.00	175		
18 x 12	0.54	0.42	7.00	167	12.00	215		
18 x 14	0.54	0.47	6.00	217	11.50	234		
18 x 16	0.54	0.50	5.00	202	10.50	246		
20 x 10	0.57	0.40	14.00	180	16.00	234		
20 x 12	0.57	0.42	12.00	205	---	---		
20 x 14	0.57	0.47	10.00	233	13.50	249		
20 x 16	0.57	0.50	7.00	250	11.50	272		
20 x 18	0.57	0.54	4.00	248	---	---		
24 x 12	0.61	0.42	16.00	308	18.00	262		
24 x 14	0.61	0.47	14.00	340	17.50	315		
24 x 16	0.61	0.50	12.00	324	15.50	328		
24 x 18	0.61	0.54	10.00	390	---	---		
24 x 20	0.61	0.57	7.00	421	---	---		

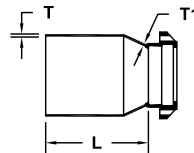

PO SMALL END BELL (SEB) REDUCER				
NOM. SIZE	T	T1	L	WT (LBS.)
6 x 4	0.38	0.34	9.50	45
8 x 6	0.38	0.36	9.50	44
12 x 6	0.42	0.36	12.50	58
12 x 8	0.42	0.38	10.50	81

STAR[®] PIPE PRODUCTS





Compact Push-On Fittings

ANSI/AWWA C153/A21.53

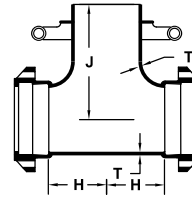
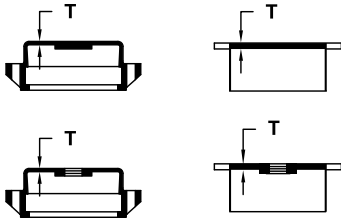

PO CAPS & PLUGS (SOLID OR TAPPED)				
NOM. SIZE	T	MAX. TAP	WT (LBS.)	
			CAPS	PLUGS
4	0.37	2	13	12
6	0.39	2	20	17
8	0.41	2	30	29
10	0.44	2	40	36
12	0.46	2	62	47
14	0.60	2.5	70	74
16	0.83	2.5	156	144
24	0.90	3	212	202

PO x SWIVEL HYDRANT TEES					
NOM. SIZE	T	T1	H	J	WT (LBS.)
6 x 6	0.36	0.36	6.00	9.50	71
8 x 6	0.38	0.36	6.00	10.50	87
10 x 6	0.40	0.36	7.00	12.50	100
12 x 6	0.42	0.36	7.00	13.50	138
16 x 6	0.50	0.36	6.50	15.00	229
20 x 6	0.57	0.36	7.00	17.50	400
24 x 6	0.61	0.36	7.00	19.50	525

Threads in Accordance with ANSI/ASME B1.20.1

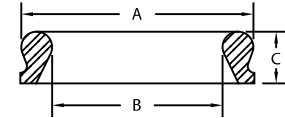
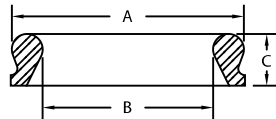

PO GASKETS			
NOM. SIZE	A	B	C
4	5.74	4.54	1.00
6	7.86	6.64	1.00
8	10.15	8.73	1.21
10	12.22	10.80	1.30
12	14.34	12.92	1.30
14	16.90	15.90	1.65
16	19.01	17.01	1.65
18	21.13	19.13	1.65
20	23.25	21.25	1.65
24	27.48	25.48	1.65

PO TRANSITION GASKETS			
NOM. SIZE	A	B	C
4	5.74	4.18	1.00
6	7.86	6.31	1.10
8	10.15	8.32	1.29
10	12.22	10.30	1.36
12	14.34	12.70	1.45



STAR[®] PIPE PRODUCTS



Standard Push-On Joint Gaskets

(SBR, NBR, EPDM, Neoprene, FKM)

ANSI/AWWA C111/A21.11

GASKET GENERAL SPECIFICATIONS

Star Pipe Products Push-On Gasket dimensions conform to the requirements for Tyton[®] style bells. Gasket markings include size, Manufacturer's mark, Country of origin and product identification. No markings are positioned on sealing surfaces per the ANSI/AWWA C111/A21.11 standard. Push-on Transition gaskets follow the requirements of ANSI/AWWA C111/A21.11 where applicable.

Standard gasket material is vulcanized styrene butadiene rubber (SBR). Special application elastomers (EPDM, Nitrile, Neoprene & FKM) are available and shall be identified on all documentation and corresponding gaskets.

Star Pipe gaskets are manufactured under quality control standards and procedures that are maintained by the gasket supplier. Appropriate documentation is maintained by the manufacturer and available for review upon request.

Star Pipe gasket suppliers maintain a quality assurance program and manual that is reviewed and updated on an ongoing basis to ensure product quality. Star Pipe gasket suppliers perform in house testing and submit to random testing by Underwriters Laboratories, Inc. Star Pipe gasket providers are recognized under the component program (UL 194/ UL 157) of Underwriters Laboratories, Inc.

Star Pipe provides that our Push-On gaskets for potable or wastewater projects will perform as designed, based on the published chemical and environmental resistance data for "generic" rubber compounds. Star Pipe should be consulted for specific recommendations or for unusual applications.

GASKET PROPERTIES			
PROPERTY	ASTM TEST METHOD	MAIN BODY	HEEL
Hardness, Shore "A"	D2240	55±5	83±5
Minimum Tensile	D412	2000 PSI	1200 PSI
Minimum Elongation	D412	300%	125%
Minimum Aging	D572	60%	---
Maximum Compression Set	D395, Method B	20%	---
Resistance to Surface Ozone Cracking	D1149	No Cracking	---

GASKET TYPE	MAXIMUM CONTINUOUS TEMP	STANDARD USAGE
SBR (Styrene Butadiene Rubber/ Buna-S)	150 F	Drinking Water, Salt Water, Sanitary Sewage, Reclaimed Water, Raw Water, Storm Water. Not Recommended for Hydrocarbon Service
EPDM (Ethylene Propylene)	212 F	Alcohols, Dilute Acids, Dilute alkalis, Ketones (MEK/Acetone), Strong Oxidizing Chemicals; Drinking Water, Salt Water, Sanitary Sewage, Reclaimed Water, Raw Water, Storm Water. Not Recommended for Hydrocarbon Service
Neoprene (Polychlorprene / CR)	200 F	Hydrocarbons, Unrefined Petroleum Products, Greasy Waste; Salt Water, Sanitary Sewage, Reclaimed Water, Raw Water, Storm Water.
Nitrile (NBR / Buna-N)	150 F	Refined Oils and Fluids, Fats, Greases and Waste; Drinking water, Sanitary Sewage, Reclaimed Water, Raw Water, Storm Water.
FKM (Flouroelastomer / Viton [®])	212 F	Aromatic Hydrocarbons, Chlorinated Hydrocarbons, Vegetable Oils, most Chemicals; Drinking Water, Reclaimed Water, Raw Water, Storm Water.

STAR[®] PIPE PRODUCTS

