

AMERICAN AVK RESILIENT SEATED GATE VALVE
250 PSI, Tested to AWWA C509 (NRS)
ANSI B16.1 Class 125 Flanged x Flanged Ends - Valve Sizes 2" - 16"

25/4X
FLxFL

Use:

For water and neutral liquids to maximum 160°F.

Tests:

Hydraulic test to AWWA C509:

Shell Test: 500 PSI

Seat Test: 250 PSI

Operating Torque Test

Optional Materials:

Stem	Option a): For UL, FM, ULC Low zinc bronze ASTM B763
Anti Friction Washers	Polyamide
Bonnet Bolts	Option a): For UL, FM, ULC ASTM A164 zinc coated steel sealed with hot melt
	Option b): Stainless Steel - 316 sealed with hot melt
Gland Bolts	Option a): For UL, FM, ULC ASTM A164 zinc coated steel Hexagon bolt
	Option b): Stainless Steel - 316 Hexagon bolt

Standard Materials:

Body, Bonnet, Gland Flange Coating	Cast iron ASTM A126 class B Ductile iron ASTM A536 Electrostatically applied fusion- bonded epoxy-resin Meets or exceeds AWWA C550
Wrench Nut	Ductile iron ASTM A536 - painted black for open left, red for open right.
Stem	Standard: Stainless Steel, ASTM A582
Wedge	Ductile iron ASTM A536 encapsulated with EPDM-rubber compound
Wedge Nut, Thrust Collar	Bronze
Bonnet Bolts	Stainless Steel - 304 sealed with hot melt
Gland Bolts Hexagon bolt	Stainless Steel - 304
Bonnet Gasket Wiper Ring, O-Ring Stem Seals, O-Ring Gland Seal	ASTM D2000 Buna "N" nitrile rubber

Approvals:



- *UL/ULC Listed,
- *FM Approved
- NSF-61 (audited by UL)
- * Approved at 200 PSI working pressure

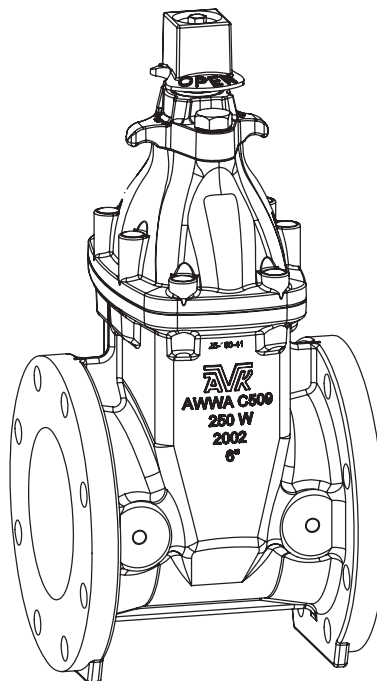

American AVK Company
an ISO 9001-2000 registered company

DS S254X FLFL
Subject to change without notice. (rev. 02/07)

AMERICAN AVK RESILIENT SEATED GATE VALVE
250 PSI, Tested to AWWA C509 (NRS)
ANSI B16.1 Class 125 Flanged x Flanged Ends - Valve Sizes 2" - 16"

25/4X
FLxFL

Component List:

217. Bonnet	227. Gland Flange Bolt	232. Lower Stem Seal O-Ring
218. Bonnet Gasket	228. Gland Flange	233. NRS Stem
219. Body	229. Gland O-Ring	234. Thrust Collar
225. Wrench Nut	230. Upper Stem Seal O-Rings	237. Wedge
226. Wiper Ring	231. Stem Seal Bushing	

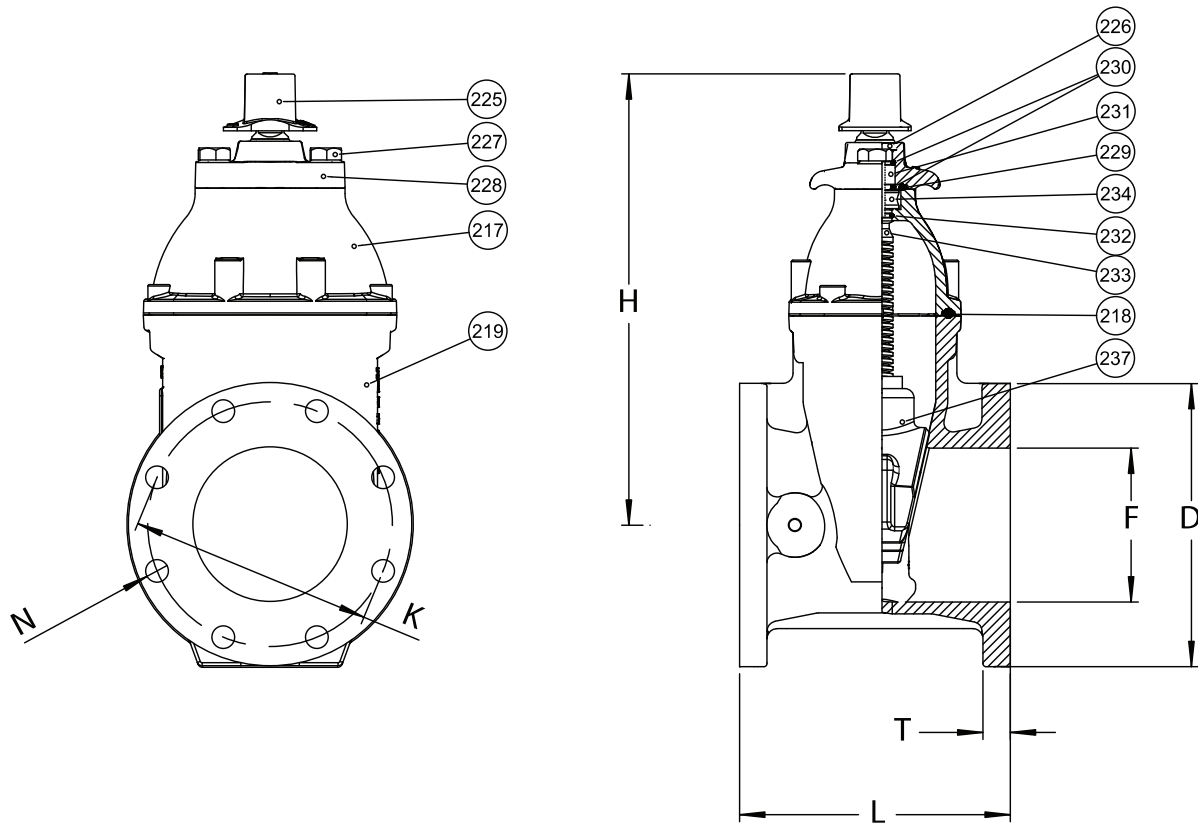

Ref No.	Size	D	F	H	K	L	N	T	Flange Holes	Turns to Open	Wt. Lbs.
25-050-4X	2"	6.00"	2.00"	10.56"	4.75"	7.00"	0.75"	0.63	4	11	29
25-065-4X	2.5"	7.00"	2.50"	12.25"	5.50"	7.50"	0.75"	0.70"	4	11	38
25-080-4X	3"	7.50"	3.00"	12.09"	6.00"	8.00"	0.75"	0.79"	4	13	43
25-100-4X	4"	9.00"	4.00"	13.50"	7.50"	9.00"	0.75"	1.00"	8	14	64
25-150-4X	6"	11.00"	6.00"	17.50"	9.50"	10.50"	0.88"	1.06"	8	21	98
25-200-4X	8"	13.50"	8.00"	21.50"	11.75"	11.50"	0.88"	1.14"	8	26	154
25-250-4X	10"	16.00"	10.00"	24.75"	14.25"	13.00"	1.00"	1.22"	12	32	269
25-300-4X	12"	19.00"	12.00"	27.63"	17.00"	14.00"	1.00"	1.30"	12	38	391
25-350-4X	14"	20.98"	13.78"	34.17"	18.75"	15.00"	1.13	1.18"	12	51	616
25-400-4X	16"	23.50"	16.00"	34.74"	21.25"	16.00"	1.13"	1.44"	16	51	789

